

SEE L600 FOR LANDING CONSTRUCTION

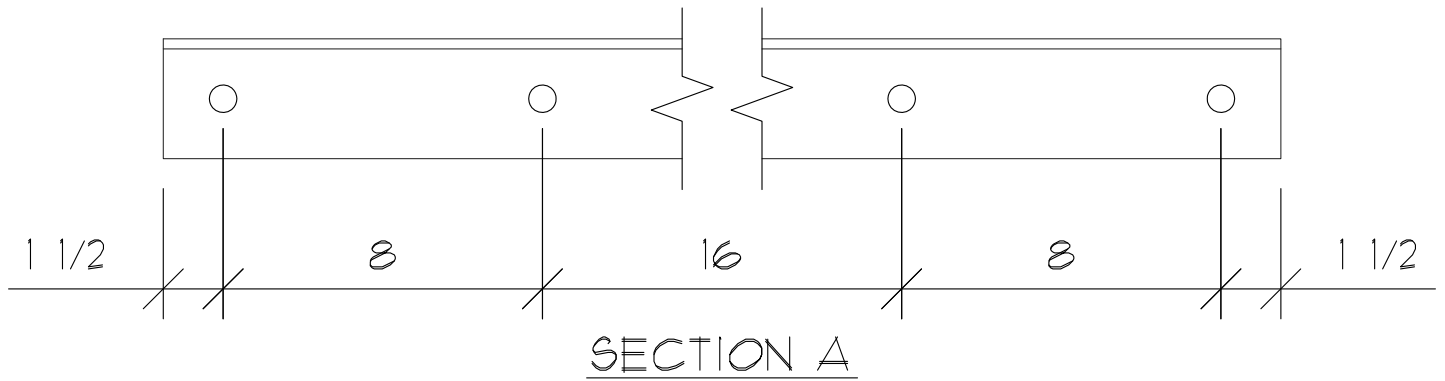

FULLY GROUTED CMU WALL (BY OTHERS)

LANDING CHANNEL  
C8x11.5# (UNO)

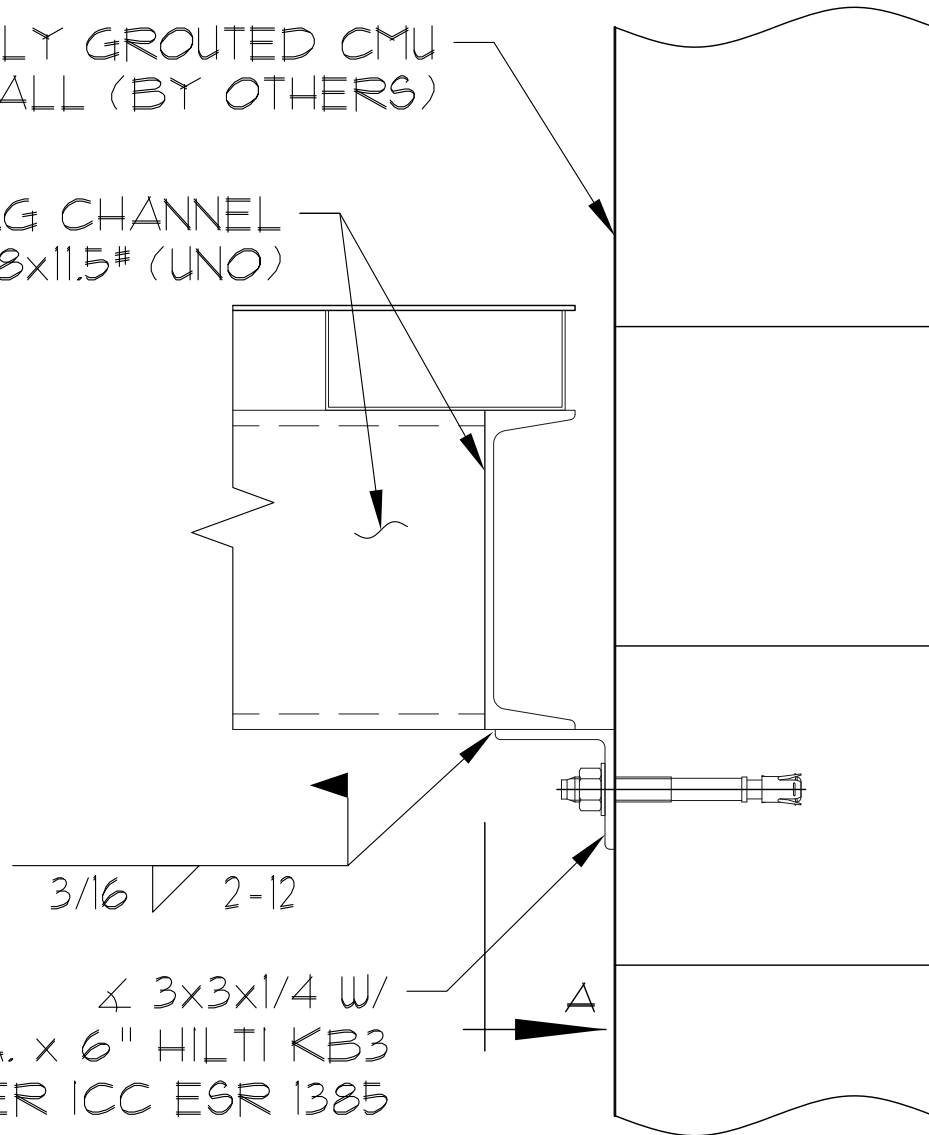

4 3x3x1/4 W/  
5/8" DIA. x 6" HILTI KB3  
INSTALL PER ICC ESR 1385

LEDGER ANGLE CONNECTION (CMU)



**PACIFIC STAIR**  
CORPORATION®

TYPE: CHECKER #

SCALE: NONE

DETAIL NO. L614